

# WK-100L

AC110V PN:884018  
 AC220V PN:884019  
 AC240V PN:884020

## INSTALLATION INSTRUCTION

Wireless Control Kit For COMEUP CWL-200/200L/301/301L Winch

**Includes:**

1. Wireless Receiver 2. Wireless Transmitter.883844 3. Power cord receptacle.884021

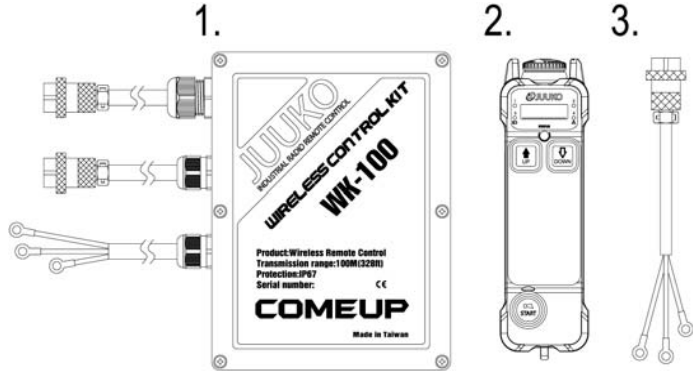

**Specifications:**

|                             |                       |  |                                |
|-----------------------------|-----------------------|--|--------------------------------|
| Control module              |                       | Indirect control +Wireless Control     |                                |
| Frequency band              |                       | 433MHz                                 |                                |
| Typical operating range     |                       | 100 M (328 ft)                         |                                |
| Applicable current          |                       | AC 110V 15A / 220V 7.5A / 240V 7.5A    |                                |
| Function                    |                       | Go up / Go down / Emergency stop       |                                |
| Control Unit                | Power Input           | Current range<br>110V OR 220V OR 240V  |                                |
|                             | Power Output          | Power cord for main power source       | 2.0 mm x 3C x1.5M              |
|                             |                       | Power cord for winch                   | 2.0 mm x 3C/3P quick connector |
|                             | contactors            | Control cord                           | 2.0 mm x 6C/6P quick connector |
|                             | Receiver              | Number                                 | 3 sets                         |
| Transmitter                 | Power supply          | AC 110V / 220V / 240V                  |                                |
|                             | Function              | Go up / Go down / built-in buzzer      |                                |
|                             | Protection degree     | IP67                                   |                                |
|                             | Button                | Emergency stop switch, Power on switch |                                |
| Environment                 | Power consumption     | 16mA                                   |                                |
|                             | Battery               | LR6(AA)1.5V*2                          |                                |
|                             | Protection degree     | IP65                                   |                                |
|                             | Operating temperature | -25°C ~ + 55°C                         |                                |
| Storage temperature         | -40°C ~ + 65°C        |  |                                |
| Humidity                    | 90%RH                 |  |                                |
| Complied with RED directive |                       | 2014/53/EU                             |                                |

**Installation Guide:**

**1.Change power lead**

a. Use a Philip screw driver to remove 3 wirings on the control panel accordingly.

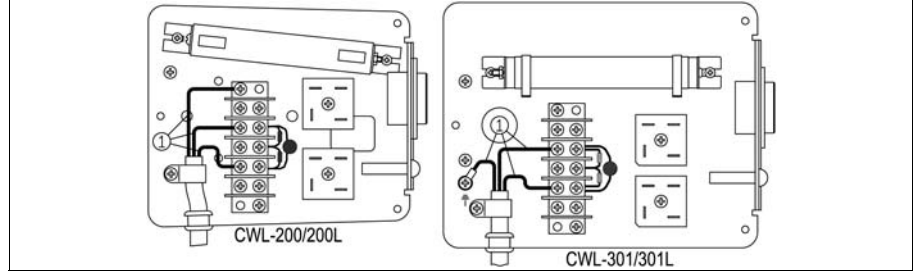

b. Use a Philip screw driver to fasten all the 3 wirings of power cord receptacle (NO.3) accordingly with 1. Green wire (Ground wire), 2.Black wire and 3.White wire.

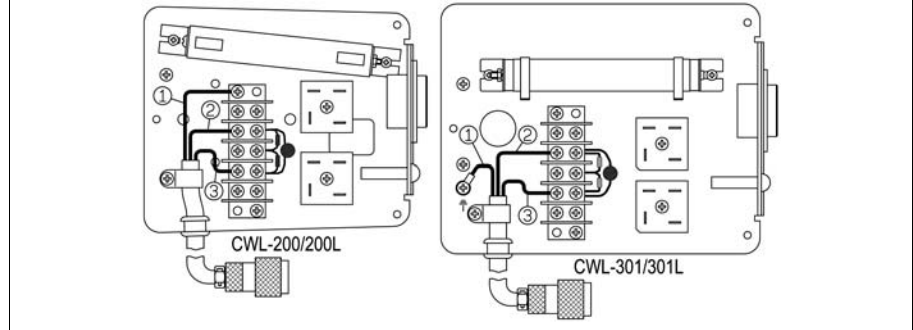

**2.Wiring**

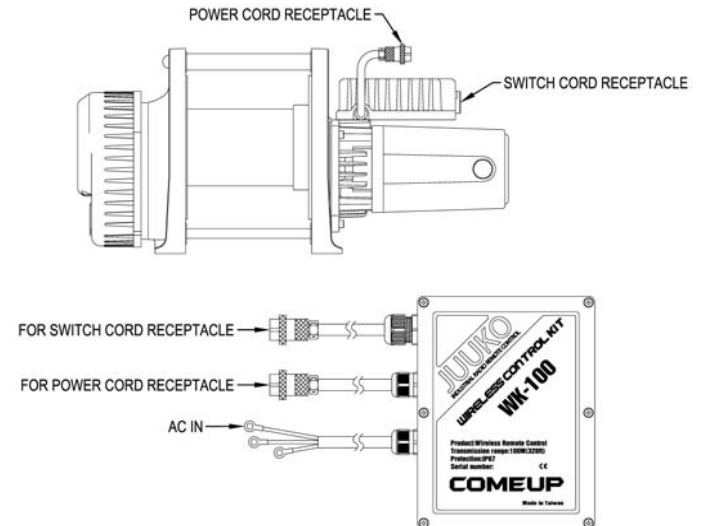

## Operation:

### 1. Install and replace battery

Remove ③ battery cap and replace batteries (1.5V,LR6 AAx2) into transmitter.

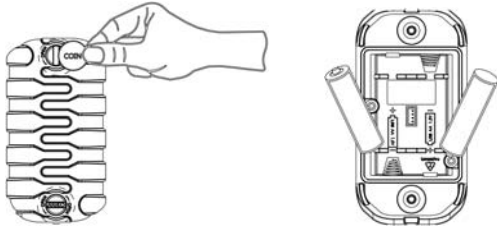

### 2. Start

a. Turn to release the ① emergency button.

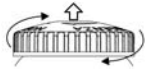

b. Press ② Start button.



※ The Start/Horn switch has 2 modes:

- (1). Press to start.
- (2). **Press for alarm before each operation.**

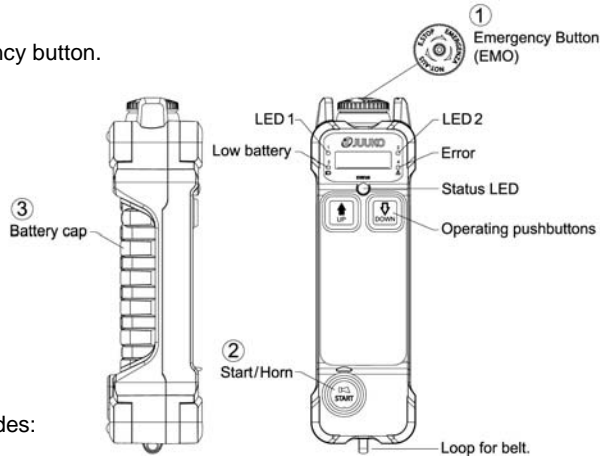

### 3. Stop

- a. Turn the transmitter off by completely pressing the ① emergency button
- b. The transmitter turns off. All relays deactivate.

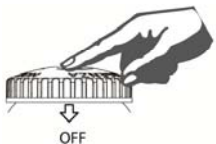

## 4. Troubleshooting

### Transmitter

| LED Signal | LED red | LED green | Failure Analysis   | Solution   |
|------------|---------|-----------|--|--|
| STATUS     | LED red | LED green | -Stain on the battery spings.<br>-Low battery.<br>-Damage batteries. | -Clean the stains on battery springs.<br>-Replace brand new batteries. |
| ⚠          | •••••   |           |  |  |
| STATUS     | LED red | LED green | -Transmitter is not communicating with receiver.                     | -Check the power supply of receiver.<br>-Check receiver's fuse.        |
| ⚠          |         | •••••     |  |  |
| STATUS     | LED red | LED green | -Push button damaged.  | -Contact the dealers.  |
| ⚠          | —••     |           |  |  |

### Receiver

Should an error occur, LED of the receiver unit will indicate the cause of the error.

| LED Signal | LED red | LED Green | Failure Analysis          | Solution   |
|------------|---------|-----------|---------------------------|--|
| STATUS     | LED red | LED Green | -RF error                 | -Check the antenna and make sure it is not loose.<br>-Contact dealer |
| ⚠          | —•••    |           |                           |  |
| STATUS     | LED red | LED Green | -Receiver is not powered. | -Change the fuse.<br>-Check the power supply.                        |
| ⚠          |         |           |                           |  |

|        |         |           |   |
|--------|---------|-----------|---|
| STATUS | LED red | LED Green | Valid data or Invalid data (from a different transmitter) received. |
| ⚠      |         | —         |   |